

**INTUMESCENT FIRE PROTECTION TECHNICAL SUPPORT**

Sherwin-Williams recognises the need to support its customers to understand the complexity that surrounds the specification of intumescent fire protection coatings in a client’s design. Collaborative work is essential to help the client and their supply chain in their quest to deliver fire-safe buildings. For over twenty years, our fire support team has been working with clients to deliver robust and complementary engineering knowledge, coupled with expertise in fire resistance design and specification of our FIRETEX® range of life safety products.



**FIRETEX® DESIGN ESTIMATOR**

Along with the group’s expertise, sophisticated design software and integration tools were needed. We collaborated with various external engineering and product testing partners, and together with the expertise of the University of Manchester’s fire-engineering facility, robust software solutions were developed. Our data is regularly revalidated to ensure results remain up to date.

This voluntary validation for the cellulosic market includes a review for accuracy of simple generic mode specifications such as section factor, correct use of appropriate product test data and the use of unfilled decking voids. This allows users to be confident that the correct coating dry-film thickness is specified to ensure fire safety compliance with specified project requirements.

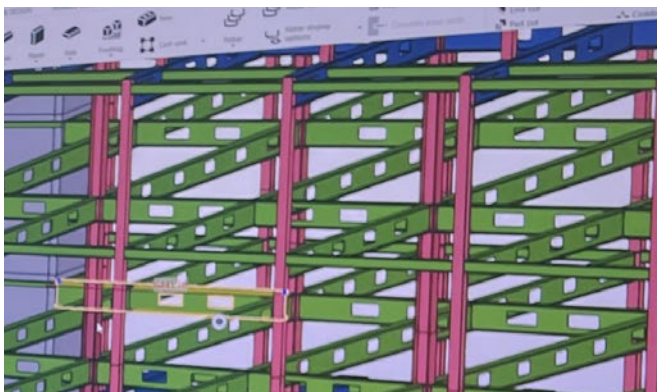

**FROM SPEC TO PROTECT**

[protectiveemea.sherwin-williams.com](http://protectiveemea.sherwin-williams.com)

# FIRETEX<sup>®</sup> TECHNICAL SUPPORT

## OUR SERVICE PACKAGE INCLUDES:

- Fire Engineering and Estimating Team (FEET) of intumescent coatings experts
- FIRETEX<sup>®</sup> Design Estimator (FDE)
- Inclusion of our environmental product declaration (EPD) carbon equivalence values providing an estimation of CO<sub>2</sub>e.
- A fully integrated plugin with our software partners at Trimble - using their Tekla Structures (TS) platform. This allows for seamless synchronisation of data between TS and our FDE suite. Product data is then able to be utilised by our clients in their 3D models and production and site control systems for use within the paint shop or on the construction site.
- The 3D BIM Model provides a contemporaneous electronic record which can support customers to comply with 'Golden Thread' requirements under the Building Safety Act.

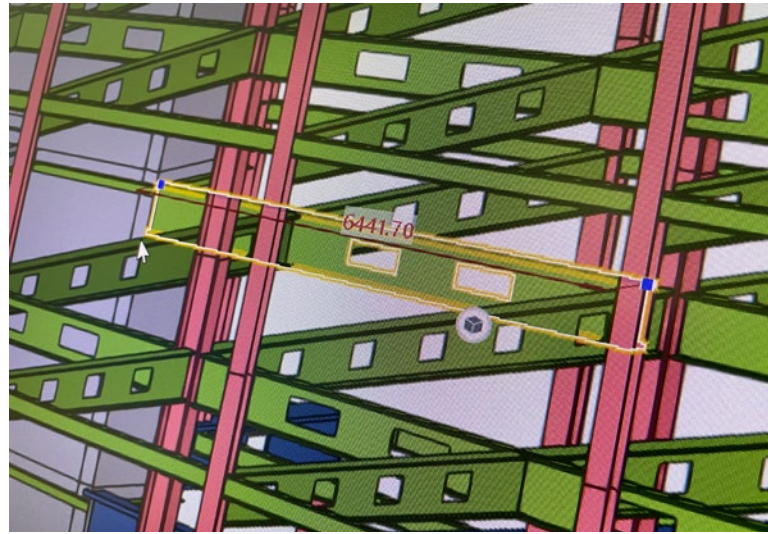

To get assistance with our FDE and FIRETEX Hub or learn more about our technical support services, contact our team of engineers/estimators.

**Tel: +44 (0)1204 556423**

**Project Enquiries: [feet.support@sherwin.com](mailto:feet.support@sherwin.com)**

**Software Enquiries: [FDE@sherwin.com](mailto:FDE@sherwin.com)**

## THE SHERWIN-WILLIAMS DIFFERENCE

Sherwin-Williams Protective & Marine delivers world-class industry subject matter expertise, unparalleled technical and specification service, and unmatched regional commercial team support to our customers around the globe. Our broad portfolio of high-performance coatings and systems that excel at combating corrosion helps customers achieve smarter, time-tested asset protection. We serve a wide array of industries across our rapidly growing international distribution footprint, including oil and gas, water and wastewater, bridge and highway, steel fabrication, flooring, food and beverage, rail and power, and marine.