

JOINT SEALANT

CEMENTITIOUS URETHANE
FLOORING

KEYED EDGE

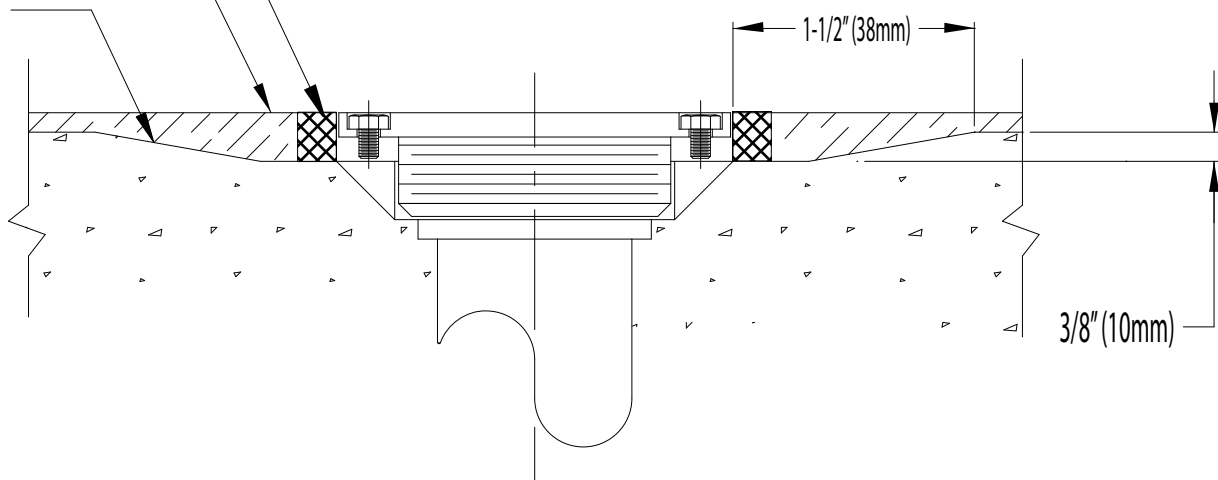

**SHERWIN
WILLIAMS®**

HIGH
PERFORMANCE
FLOORING

sherwin-williams.com/resinflooring
(660) 638-5089

TITLE

POLY-CRETE FLOORING

DRAIN DETAIL with SEALANT

DATE

2/25

SCALE

AS NOTED

DWG NO.

PCSL-13A

PROJECT