

CEMENTITIOUS URETHANE FLOORING

1/3 DEPTH OF SLAB  
OR 1-1/2" (38mm) MIN

FLEXIBLE JOINT SEALANT

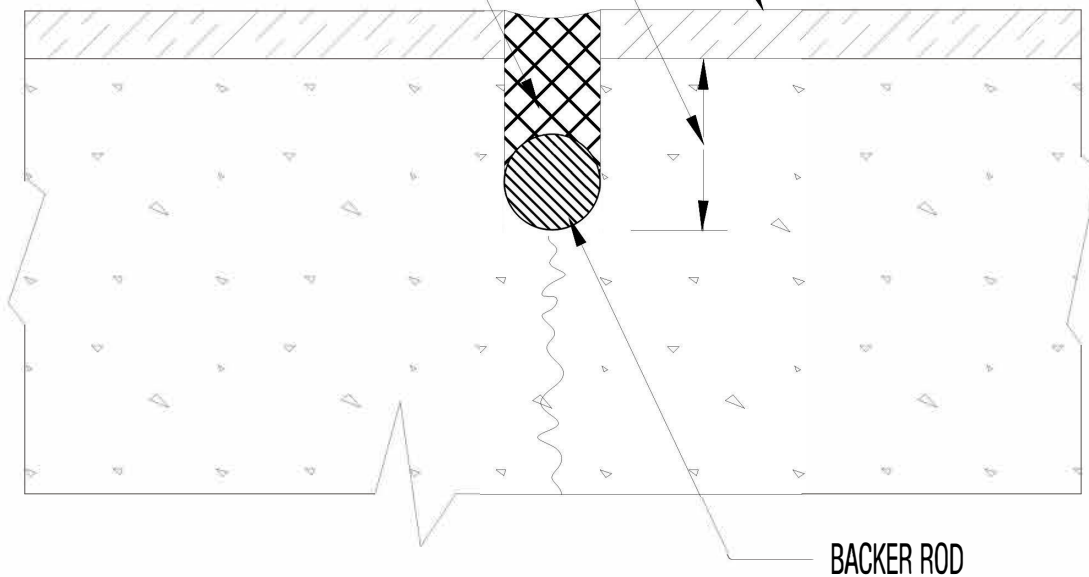

BACKER ROD

**SHERWIN  
WILLIAMS®**

HIGH  
PERFORMANCE  
FLOORING

sherwin-williams.com/resinflooring  
(660) 638-5089

TITLE

**POLY-CRETE SLB**

CONTROL JOINT DETAIL (MOVEMENT)

DATE

11/21

SCALE

NTS

DWG NO.

**PCSL-5**

PROJECT